

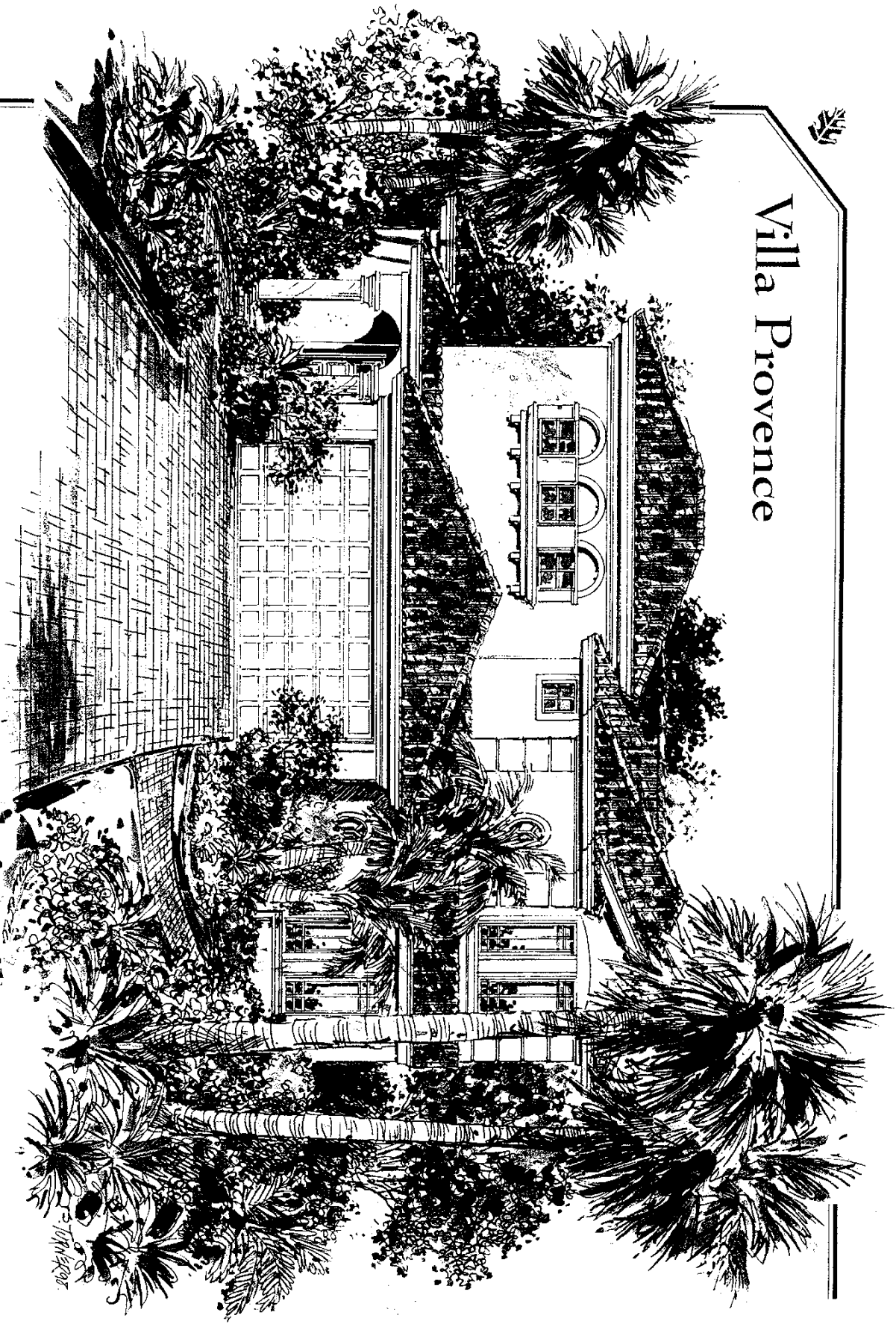

Villa Provence



La Residence de L'Ermitage

Grey Oaks

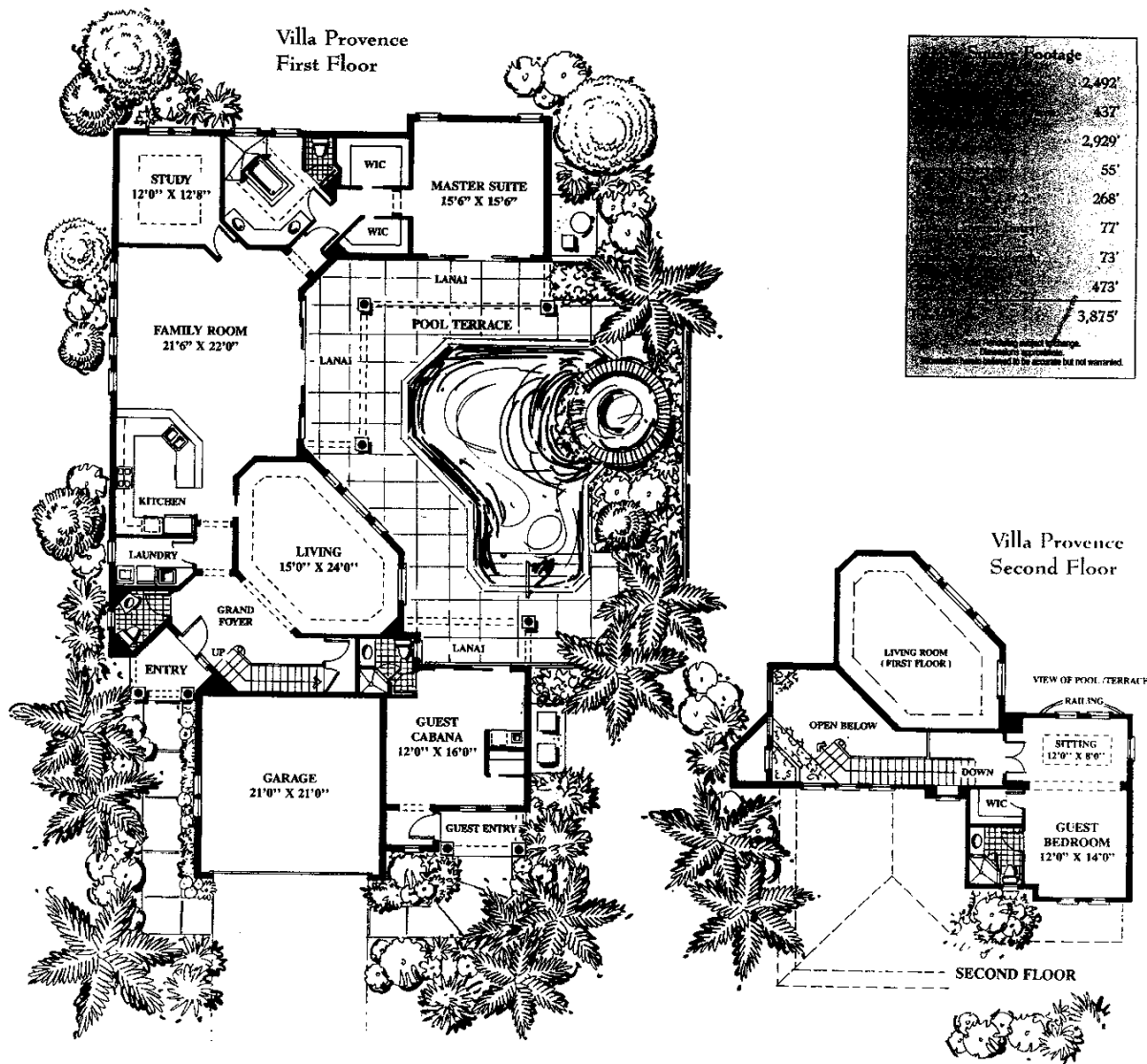

Villa Provence

La Residence Courtyard Home

Interior Features

- Majestic two-story courtyard villa with three bedrooms, three baths and powder room.
- 2,492 square feet under air on the first floor, 437 square feet on the second floor.
- Keystone columns flank the covered entry leading to the Grand Foyer staircase to the second floor. A powder room is located to one side.
- The centrally located living room offers expansive views of the large inner courtyard & pool.
- The Guest Cabana is arranged for privacy at one end of the villa. It has it's own separate entrance with covered porch, kitchen/wet bar, and full bath with tiled walk-in shower.
- The designer kitchen has custom Euro-style cabinetry in a choice of finishes, upper cabinets with crown molding, Kitchen Aid appliances, matching cabinet panels for the dishwasher and refrigerator and Wilsonart Corian-type countertops.
- The expansive family room has glass walls opening onto a covered porch and inner courtyard.
- The study is located off the family room and has wood floors.
- The secluded master suite features privacy entrance and his and her closets.
- The luxurious master bath has Italian ceramic tile floor, his and her vanities with marble countertops and custom Euro-style cabinetry, Roman tub, ceramic tile walk-in shower with seat, and separate water closet.

- The second guest bedroom is located on the second floor and has a full bath with ceramic tile walk-in shower and walk-in closet and sitting room.
- Separate laundry room with large capacity Whirlpool appliances, cabinets and laundry tub.
- Crown moldings can be found in the foyer, living, dining, master and guest suites, powder room, study and guest bath.
- Integrated security system connecting to the gate house and off-site security center.

Exterior Features

- Mediterranean style stucco exterior with keystone trim.
- Espana Lifetile concrete roof tile.
- Custom free-form pool, brick paver patio with planter areas, lush tropical landscaping.
- Insulated windows with custom grills, and 10-foot glass sliding doors.
- Decorative keystone pavers and columns at entry, keystone trim in selected areas.
- High efficiency, two-zone air conditioning system.
- Large two-car garage with 18-foot garage door.
- Brick courtyards with security lighting.
- Lush tropical landscape at front courtyard and patio area by pool.