

# MANCHESTER V

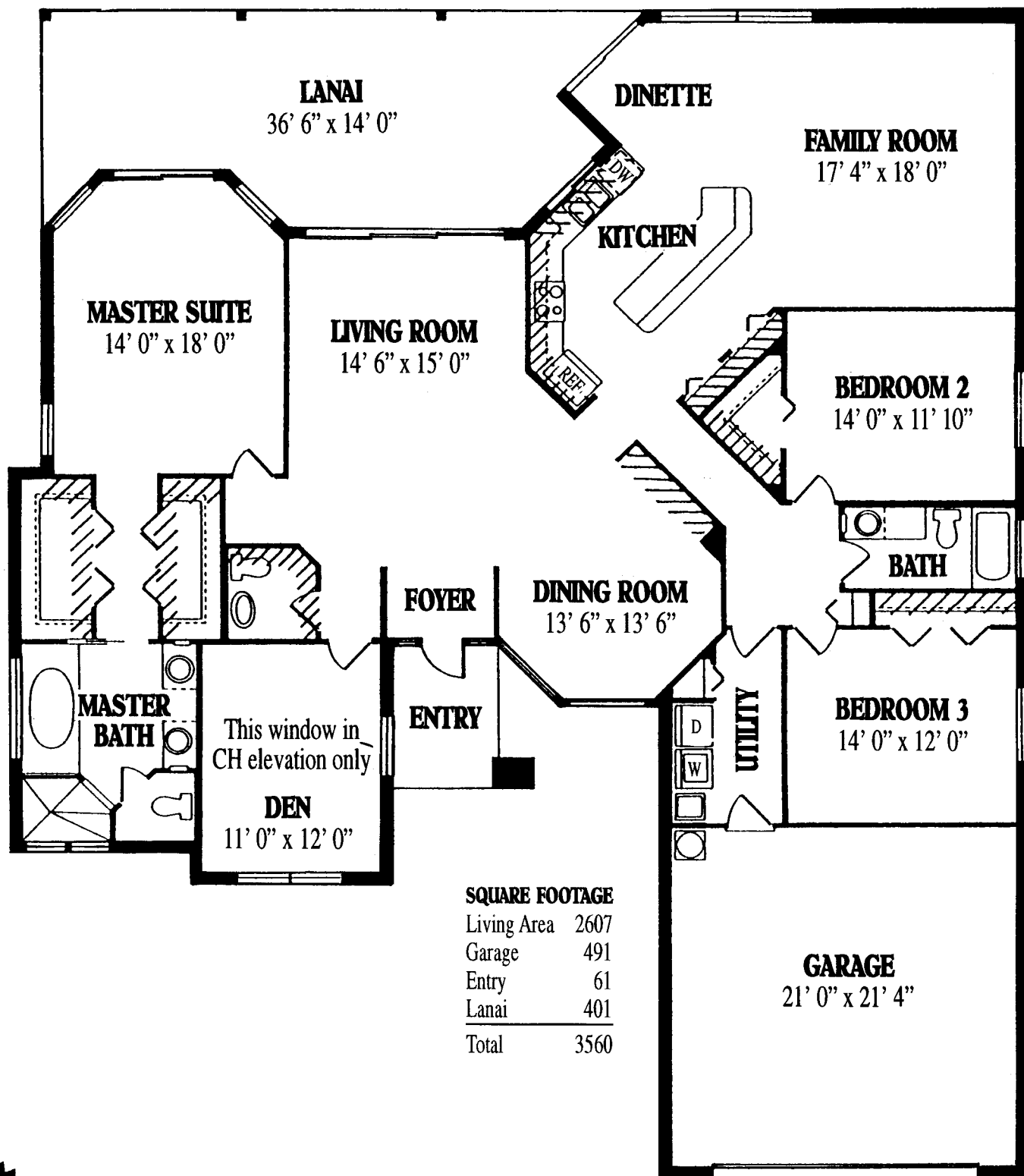

A view to the outdoors is guaranteed from every room in the Manchester floor plan. The master suite has impressive space and light from its large bay window, along with oversized windows above the master bath tub and in the shower. An octagon shaped dining area is ideal for entertaining. Angled walls throughout give the Manchester a uniqueness all its own. An elaborate plan, with rooms that flow together, make this a perfect place to come home to.

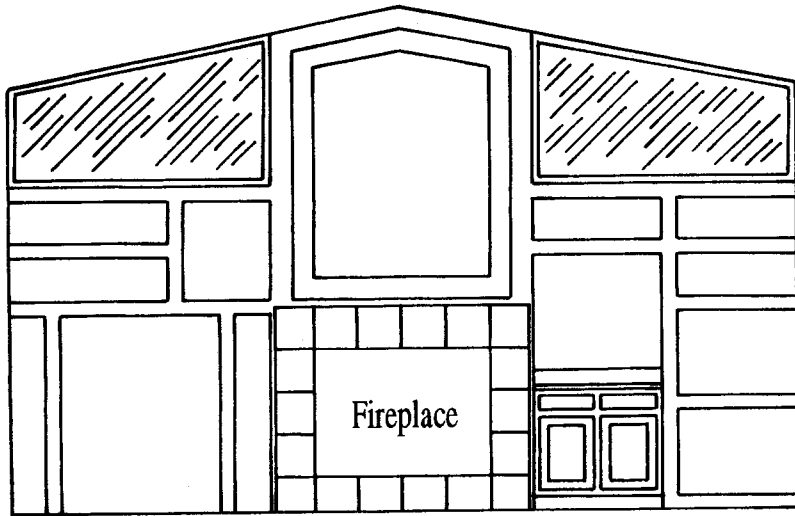



**BUILT-IN WITH FIREPLACE IN FAMILY ROOM**  
 (Available only with Cathedral Ceiling)

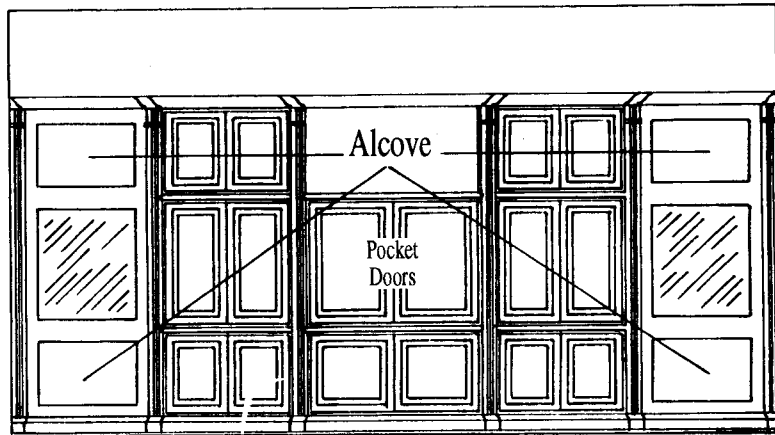
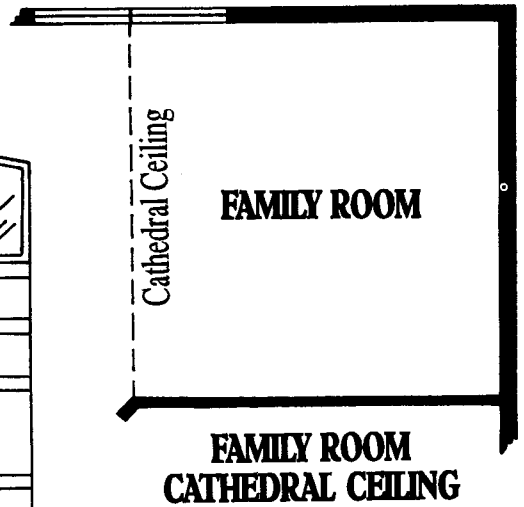

**ENTERTAINMENT CENTER IN FAMILY ROOM**

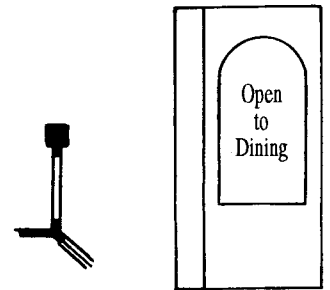

**12" x 12" COLUMN  
 AT FOYER & OPENING  
 TO DINING ROOM**

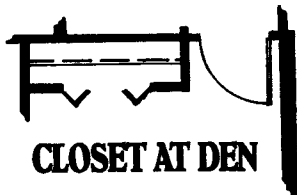

**CLOSET AT DEN**



**DOUBLE  
 ENTRY DOORS**



**BAY WINDOW AT DEN**  
 Additional Living Area 21' sq. ft.

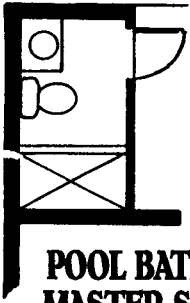

**POOL BATH AT  
MASTER SUITE**



**POOL BATH AT  
FAMILY ROOM REAR**



**FAMILY ROOM BAY WINDOW**  
Additional Living Area 34' sq. ft.

**POOL BATH AT  
FAMILY ROOM SIDE**

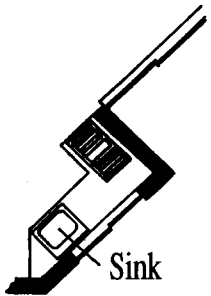
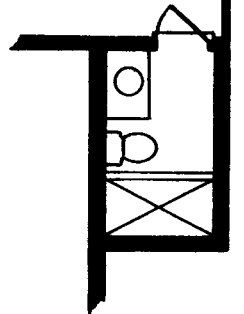

**OUTDOOR  
COOK CENTER**

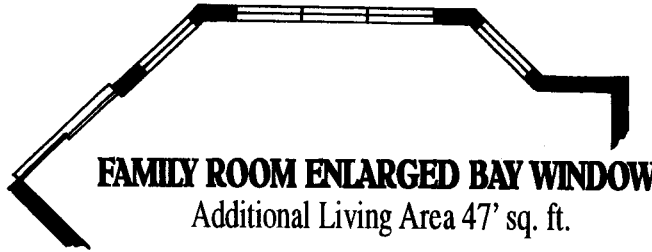

**FAMILY ROOM ENLARGED BAY WINDOW**  
Additional Living Area 47' sq. ft.

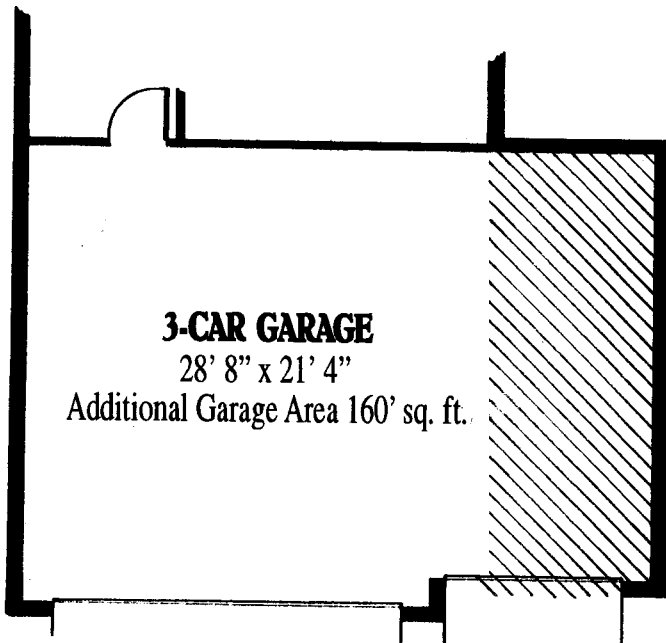

**3-CAR GARAGE**  
28' 8" x 21' 4"  
Additional Garage Area 160' sq. ft.

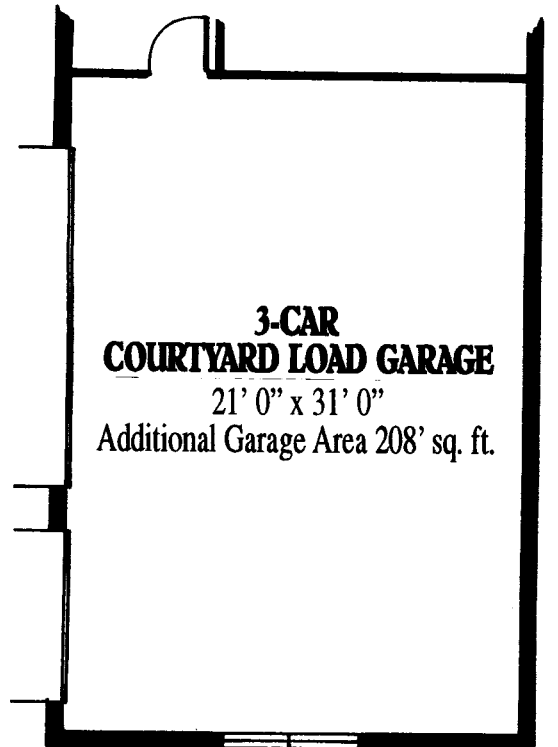

**3-CAR  
COURTYARD LOAD GARAGE**  
21' 0" x 31' 0"  
Additional Garage Area 208' sq. ft.

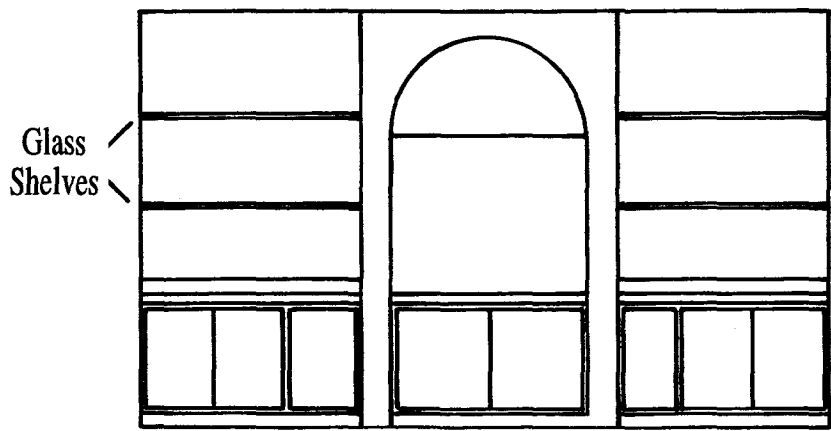

Glass Shelves

**BUILT-IN ENTERTAINMENT CENTER IN FAMILY ROOM**

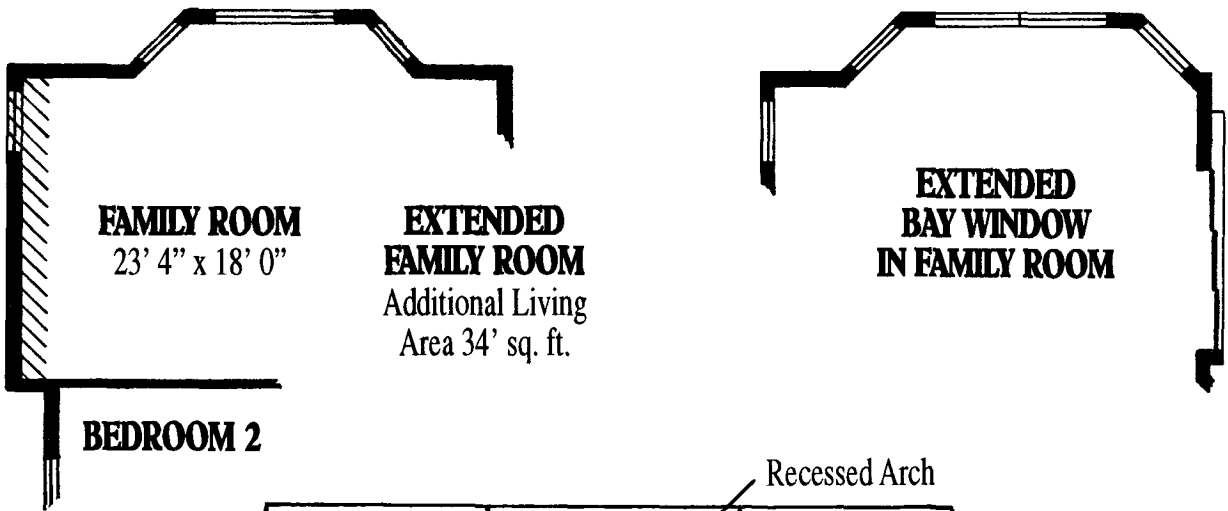

**FAMILY ROOM**  
23' 4" x 18' 0"

**EXTENDED FAMILY ROOM**  
Additional Living Area 34' sq. ft.

**EXTENDED BAY WINDOW IN FAMILY ROOM**

**BEDROOM 2**

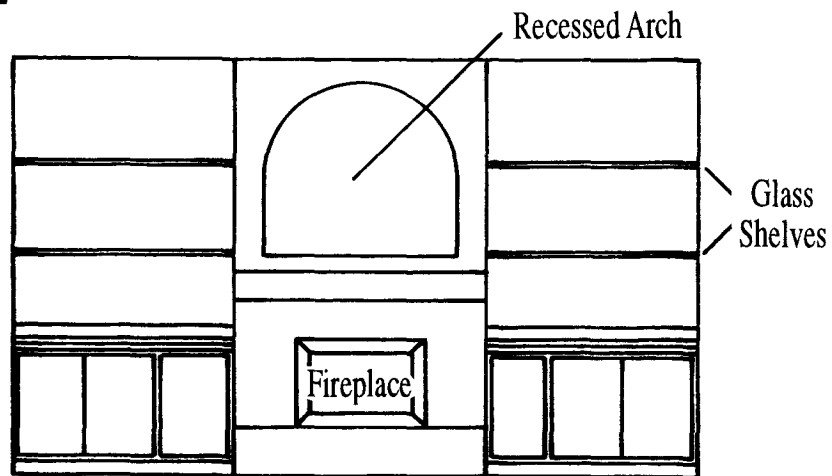

Recessed Arch

Glass Shelves

**BUILT-IN WITH FIREPLACE IN FAMILY ROOM**