

# Residence Three

Enclosed area: 1710 sq. ft.  
Balcony area: 135 sq. ft.  
Total area: 1845 sq. ft.

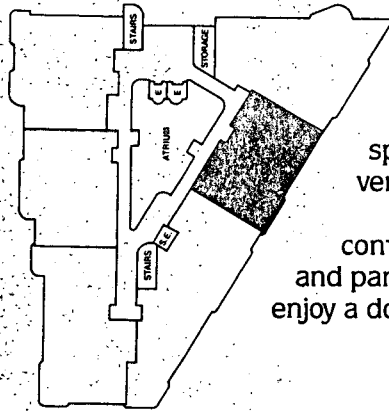

A distinctive L-shaped living room and adjoining dining area highlight this thoughtfully designed home, which features two bedrooms, two full baths, and a spectacular view of the Gulf of Mexico from its very private balcony. Separated from the dining area by a counter island, the spacious contemporary kitchen has both a breakfast area and pantry, while in the master bedroom suite you'll enjoy a double bowl vanity area and abundant storage space provided by two huge walk-in closets.

